

DW - DW VOX

SUBMERSIBLE ELECTRIC PUMPS FOR FOUL WASTE WATER in AISI 304 stainless steel

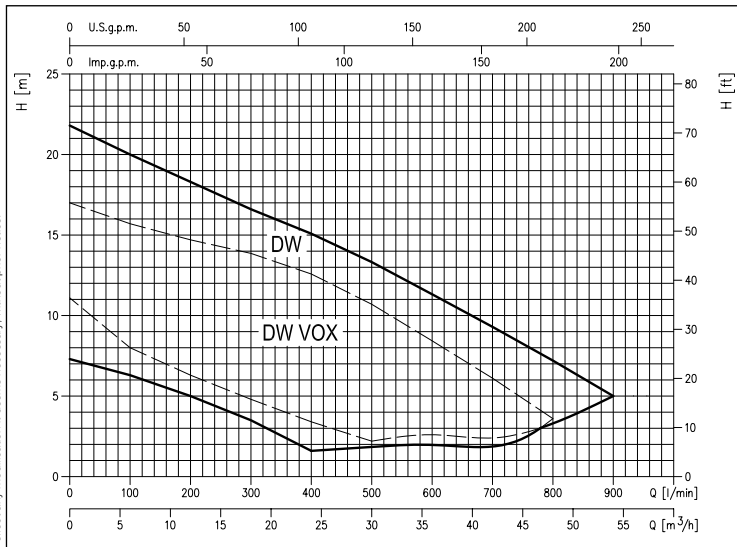

PERFORMANCE RANGE (per ISO 9906 Annex A)



Submersible electric pumps in AISI 304 stainless steel for foul waste water.

APPLICATIONS

- Evacuation of civil and industrial waste water
- Drying wells and excavations
- Draining underground areas
- Handling fluids containing suspended solids / filaments
- Draining infiltration water
- Handling foul waste water (domestic services)
- Draining cesspits

TECHNICAL FEATURES

- Fitted with 10 m power cable, type H07 RN-F (single phase), type FG50K (three-phase)
- Available with/without float switch
- Equipped with single-channel or vortex impeller (VOX) and flanged (F)

TECHNICAL DATA

- Maximum submersion: 7 m
- Maximum fluid temperature: 40°C
- Maximum solid dimensions: 50 mm
- 2 pole self-ventilating asynchronous motors
- Insulation class F
- Protection rating IPX8
- Single phase voltage 230V ±10%, 50Hz, three-phase voltage 400V ±10%, 50Hz
- Permanently active condenser and integrated automatic re-arming thermal cutout for the single phase motor
- Protection must be supplied by the user for the three-phase version
- Threaded version: suction ø 50, delivery G2
- Flanged version: delivery ø 50 DN 50

MATERIALS

- Pump body, impeller, motor cover, gasket disk and motor casing in AISI 304 stainless steel
- Shaft made of AISI 303 stainless steel
- Double mechanical seal with oil chamber:
 - upper seal in Carbon/Ceramic/NBR (motor side)
 - lower seal in SiC/SiC/NBR (pump side)
- Spacer in G20 cast iron (DW-DW VOX 300 only)

SPECIAL VERSIONS

- VOX version (VORTEX impeller)

ACCESSORIES (on request)

- Cast iron DW lowering device kit - threaded 2"
- Steel DW lowering device kit - threaded 2"
- Steel DW lowering device kit - flanged DN50

For accessories and electrical enclosures, see page 151 onwards

IDENTIFICATION CODE

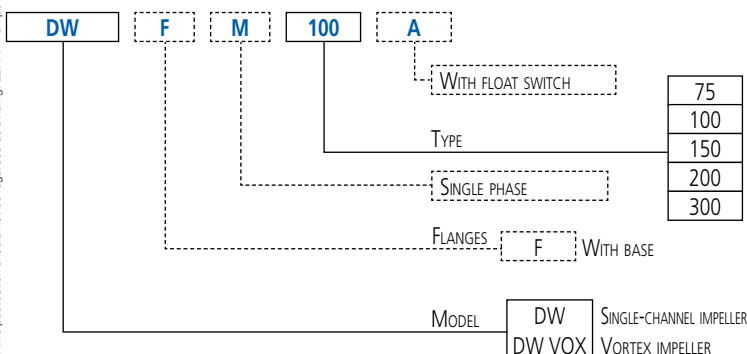

The contents of this publication should not be regarded as binding. EBARA Pumps Europe S.p.A. reserves the right to effect any modification it deems necessary, without prior notice.

DW - DW VOX

SUBMERSIBLE ELECTRIC PUMPS FOR FOUL WASTE WATER
in AISI 304 stainless steel

PERFORMANCE CURVES DW (per ISO 9906 Annex A)

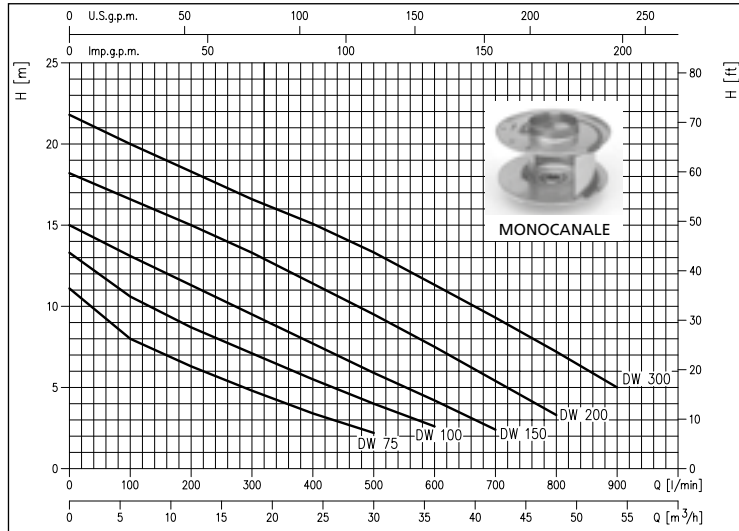

PERFORMANCE CURVES DW VOX (per ISO 9906 Annex A)

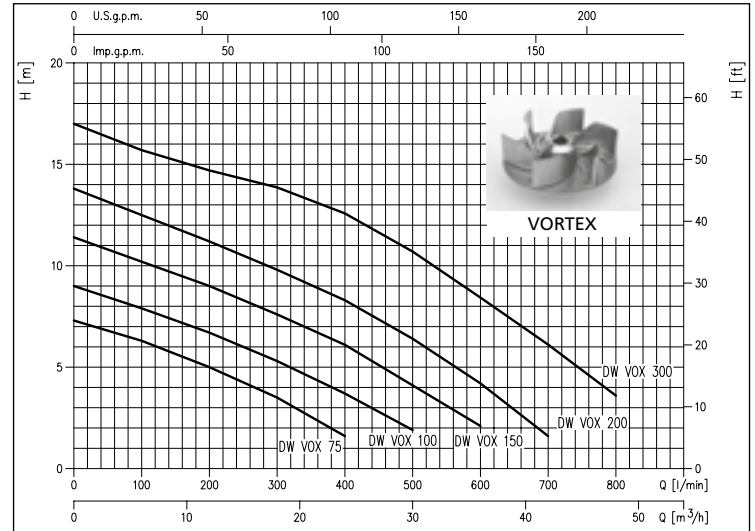

PERFORMANCE TABLE

Model		P ₂		Capacitor		Abs. Curr. [A]		Q=Flow rate										
Single phase 230V	Three phase 400V	[HP]	[kW]	µF	Vc	1~	3~	l/min m³/h	100	200	300	400		500	600	700	800	900
									6	12	18	24	30	36	42	48	54	
								H=Head [m]										
DW 75 M	DW 75	0.75	0.55	20	450	3.9	1.5	8.0	6.3	4.8	3.4	2.2	-	-	-	-	-	-
DW 100 M	DW 100	1	0.75	25	450	5.9	2.1	10.6	8.7	7.1	5.5	4.0	2.6	-	-	-	-	-
DW 150 M	DW 150	1.5	1.1	31.5	450	7.3	2.8	13.1	11.3	9.5	7.7	5.9	4.2	2.4	-	-	-	-
	DW 200	2	1.5	-	-	-	3.6	16.6	15.0	13.3	11.4	9.5	7.5	5.4	3.3	-	-	-
	DW 300	3	2.2	-	-	-	5	20.0	18.3	16.6	15.1	13.3	11.3	9.3	7.2	5.0	-	-
DW VOX 75 M	DW VOX 75	0.75	0.55	20	450	3.9	1.4	6.3	5.0	3.5	1.6	-	-	-	-	-	-	-
DW VOX 100 M	DW VOX 100	1	0.75	25	450	5.8	2.1	7.9	6.7	5.3	3.7	1.9	-	-	-	-	-	-
DW VOX 150 M	DW VOX 150	1.5	1.1	31.5	450	7.3	2.8	10.2	9.0	7.6	6.1	4.1	2.1	-	-	-	-	-
	DW VOX 200	2	1.5	-	-	-	3.3	12.5	11.2	9.8	8.3	6.4	4.2	1.6	-	-	-	-
	DW VOX 300	3	2.2	-	-	-	4.4	15.7	14.7	13.9	12.6	10.7	8.4	6.1	3.6	-	-	-

DIMENSIONS DW - DW VOX

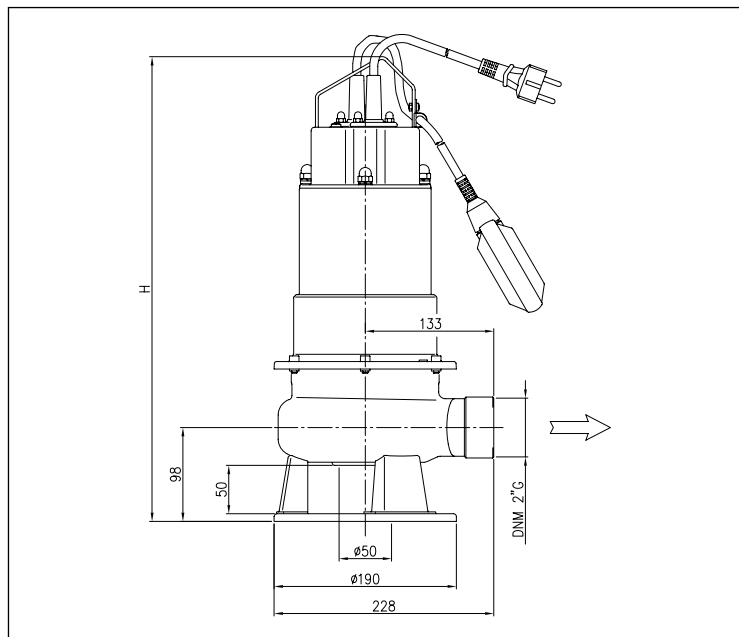

DIMENSIONS DWF - DWF VOX

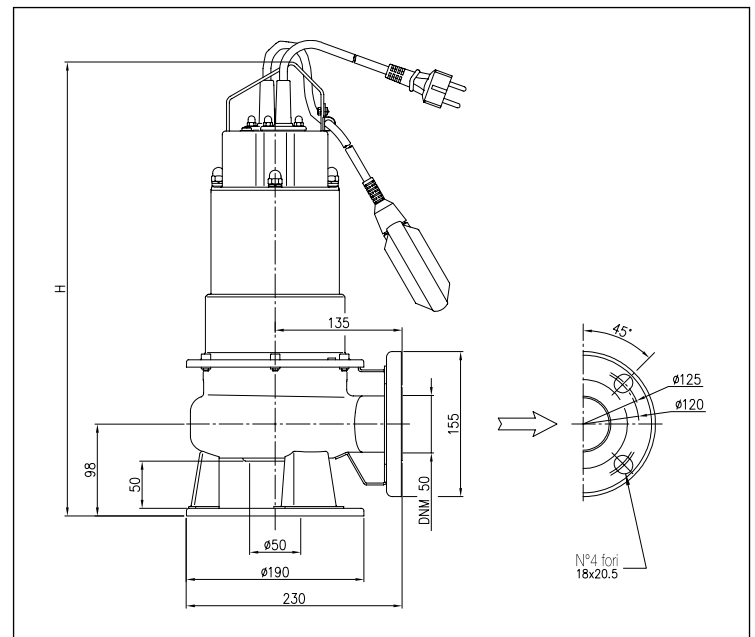

DW - DW VOX

SUBMERSIBLE ELECTRIC PUMPS FOR FOUL WASTE WATER
in AISI 304 stainless steel

DIMENSIONS MOUNTING KIT DW-DW VOX

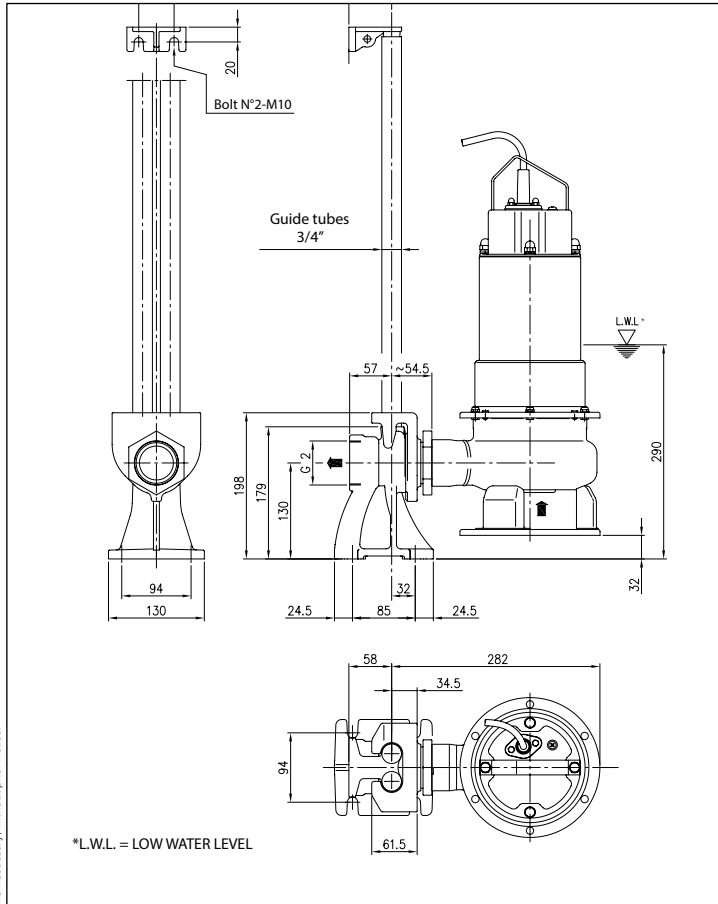

DIMENSIONS CHART

Model		Dimensions [mm]		Weight [kg]	
		1~	3~	1~	3~
DW 75	DW VOX 75	486	486	16	15.4
DW 100	DW VOX 100	516	486	18	16.8
DW 150	DW VOX 150	516	516	19.4	18.6
DW 200	DW VOX 200	-	516	-	20
DW 300	DW VOX 300	-	546	-	25.8

Model		Dimensions [mm]		Weight [kg]	
		1~	3~	1~	3~
DWF 75	DW VOXF 75	486	486	16.8 (16.4)	16.2 (16)
DWF 100	DW VOXF 100	516	486	18.8 (18.4)	17.6 (17.2)
DWF 150	DW VOXF 150	516	516	20.2 (19.8)	19.4 (18.9)
DWF 200	DW VOXF 200	-	516	-	20.8 (20.4)
DWF 300	DW VOXF 300	-	546	-	26.6 (26.2)

INSTALLATION

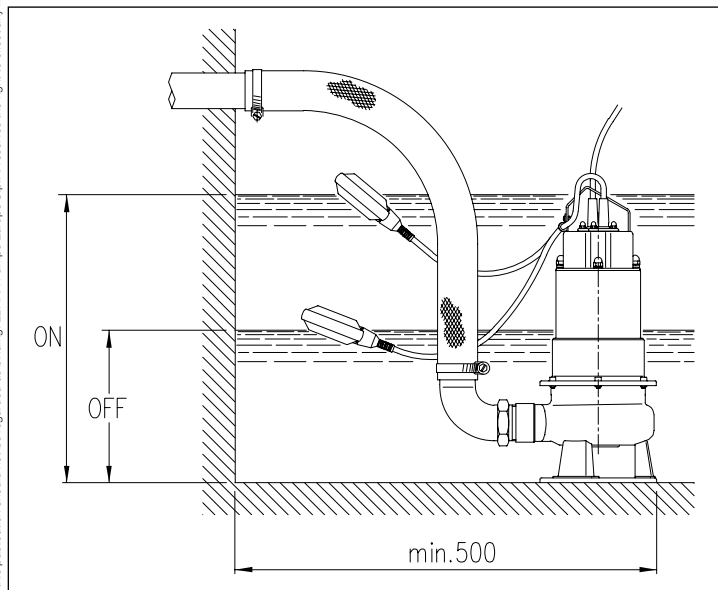

The contents of this publication should not be regarded as binding. EBARA Pumps Europe S.p.A. reserves the right to effect any modification it deems necessary, without prior notice.

DW - DW VOX

SUBMERSIBLE ELECTRIC PUMPS FOR FOUL WASTE WATER in AISI 304 stainless steel

SECTIONAL VIEW

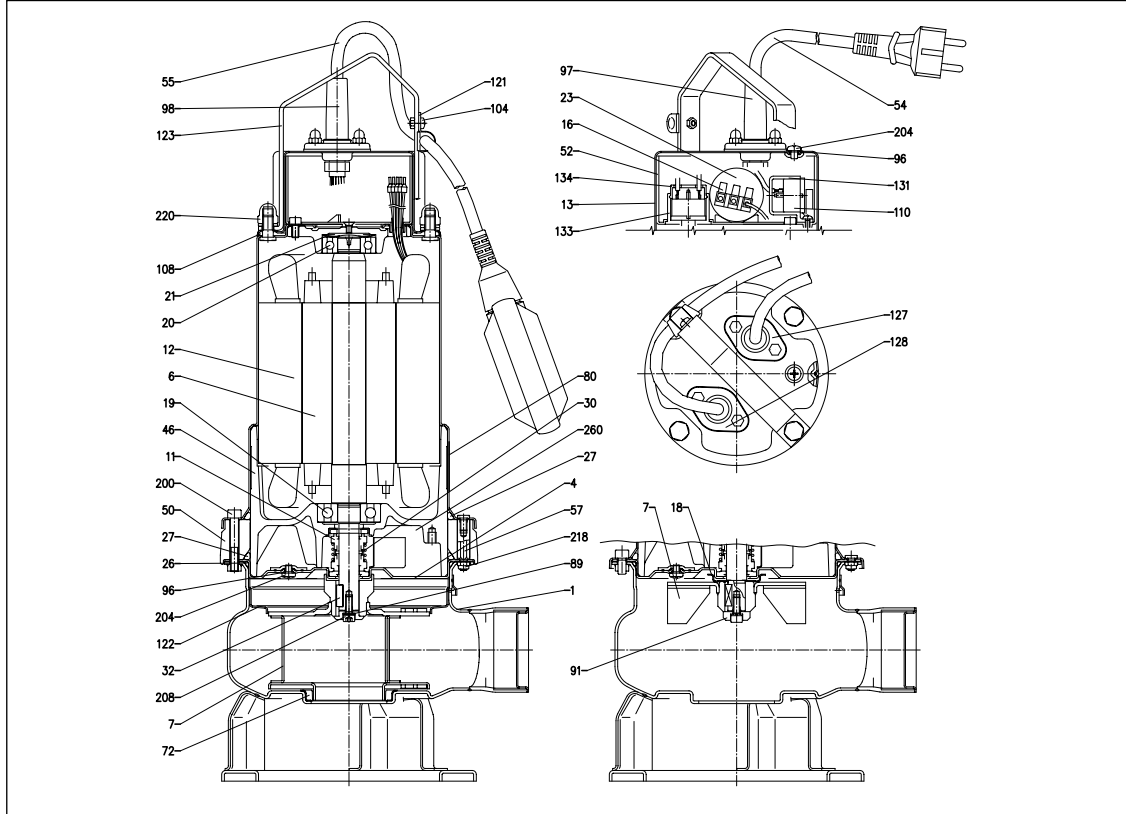

MATERIALS TABLE

Ref.	Name	Material	Ref.	Name	Material
1	Pump body	AISI 304 stainless steel	57	Spacer [3]	AISI 304 stainless steel
4	Gasket disk	AISI 304 stainless steel	72	Clearance ring [5]	NBR
6	Rotor shaft	AISI 303 stainless steel	89	Washer	AISI 304 stainless steel
7	Impeller	AISI 304 stainless steel	91	Washer [1]	AISI 304 stainless steel
11	Pump side mechanical seal	SiC/SiC/NBR	96	O-ring	NBR
11	Motor side mechanical seal	Carbon/Ceramic/NBR	97	Power cable	NBR
12	Casing	-	98	Float cable gland [4]	NBR
13	Motor cover	AISI 304 stainless steel	104	Float cable gland [4]	NBR
16	Terminal block	-	108	Motor cover gasket	NBR
18	Seal protection [1]	AISI 304 stainless steel	110	Motor protection device [2]	-
19	Pump side bearing	-	121	Float switch mount [4]	AISI 304 stainless steel
20	Motor side bearing	-	122	Impeller protector ring [6]	AISI 304 stainless steel
21	Compensator ring	C70 steel	123	Lifting hook	AISI 304 stainless steel
23	Condenser [2]	-	127	Cable connector	AISI 304 stainless steel
26	O-ring	NBR	128	Connector [4]	AISI 304 stainless steel
27	O-ring	NBR	131	Motor cutout mount [7]	PA66 reinforced with glass fibre
27	O-ring [3]	NBR	133	Motor cutout sensor mount [7]	Aluminium
30	Mechanical seal spacer	Brass	134	Motor cutout sensor mount cover [7]	PA6
32	Key	AISI 304 stainless steel	200	Bolt	Steel A2 UNI 7323
46	Bearing mount	G20	204	Bolt	Steel A2 UNI 7323
50	Spacer [3]	G20	208	Bolt	Steel A2 UNI 7323
52	Capacitor housing	PA66 reinforced with glass fibre	218	Nut	Steel A2 UNI 7323
54	Power cable	-	220	Nut	Steel A2 UNI 7323
55	Float [4]	-	260	Lubricant	Oil

[1] Except for DW-DW VOX 300
[2] Single phase only

[3] DW-DW VOX 300 only
[4] Single phase without float only

[5] DW only
[6] Except for DW VOX 150, 200 and 300

[7] DW150 single phase only